



FEATURES

- Fully factory assembled and tested
- No field assembly required
- Just connect water supply, drain, and field electrical devices
- Attractive and rugged metal enclosure
- Easy-to-see gages on front of enclosure
- Easy access to manual release valve
- Installation drawings available
- Lower and upper water inlet connections
- Space for required spare sprinkler heads and wrench
- Separate mechanical and electrical enclosures
- UL / FM / MEA major components
- Complies with NYCFD Information Bulletin #1-92
- 1-1/2" thru 6" valve options
- Ready for connection of NITROGEN-PAC™ Sprinkler Corrosion Inhibiting System

BENEFITS

- Saves assembly time
- Quicker commissioning – just place, connect, and it's ready
- Finished appearance allows placement in or near hazard
- Easy inspection and maintenance
- Rapid access to manual release handle
- Reliable, dependable protection that functions as designed
- Expert field and in-house technical support

DESCRIPTION

The UNITED Fire Systems PREACTION-PAC™ is a fully assembled pre-action fire suppression system, including pre-action valve and trim, providing one complete zone of pre-action water sprinkler fire protection. All components are contained in two steel enclosures assembled one above the other. The system pressure gages and the required manual release handle are mounted on the front of the lower enclosure. The valve switch and solenoid connections are located behind a door in the upper enclosure. Lockable latches on both doors permit authorized access to all system components. Both enclosures are finished in powder-coat red paint. Gasketing provides sealing of the enclosure doors. Knockouts permit easy attachment of external electrical conduits.

Preaction Valve

The preaction valve installed in the PREACTION-PAC™ is a low-differential, latched clapper valve that uses a unique direct-acting diaphragm to separate the system water supply from the system piping. The positive latching system uses the supply water pressure to hold the clapper shut. When the water pressure in the diaphragm chamber is released, the latch retracts from the clapper and the valve actuates. The low differential and unique latch and actuator design of the valve allows the valve to be self-resetting.

Nitrogen-Ready

The PREACTION-PAC™ is ready for connection of a UNITED Fire Systems NITROGEN-PAC™ sprinkler corrosion inhibiting system. An inlet port is conveniently located near the outlet riser. This port is attached to the inlet of a built-in air maintenance device, whose outlet is pre-connected to the preaction valve trim.

Piping

Water inlet pipe connections are located on the lower left side and the upper right corner of the lower enclosure. The unused inlet is left plugged. Grooved pipe is used for the inlet connection. All inlet pipe connections are done in the lower enclosure. The outlet riser connection is behind the upper enclosure, at the center line of the cabinet.

Wiring

A terminal strip in the upper enclosure provides easy access to connections for waterflow, low air, and water shutoff supervisory switches, as well as the valve actuation solenoid. No access to the lower enclosure is necessary to complete the wiring installation.





Detection Control Panel

The assembly shown does not include a detection control panel. A separate panel must be provided to make a complete fire suppression system.

Options

- NITROGEN-PAC™ self-contained (SC Series) or modular (M Series) nitrogen sprinkler corrosion inhibiting system.
- Choice of pre-action valve size (1-1/2" through 6" available)

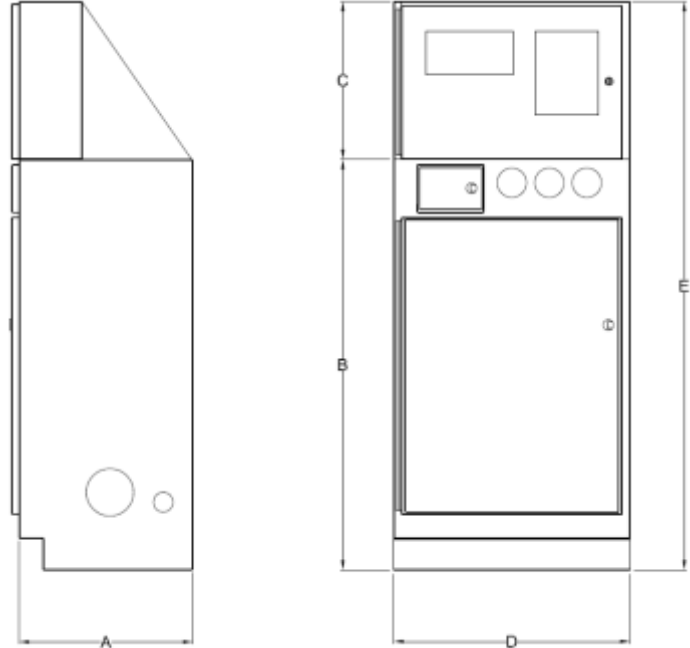

SIDE VIEW

FRONT VIEW

Ordering Information

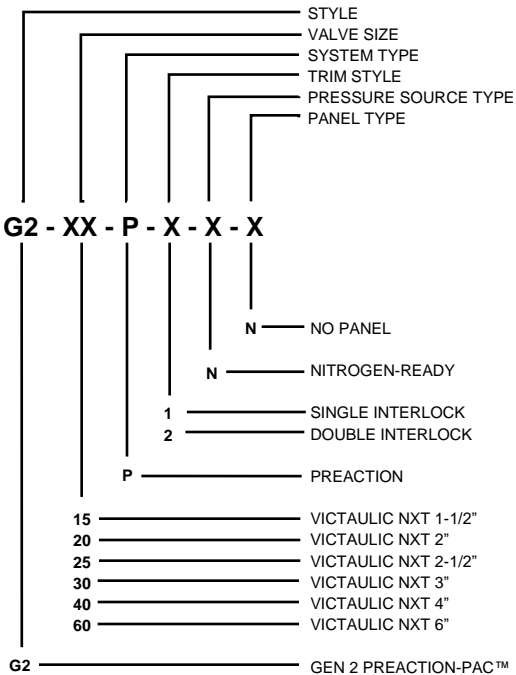

| Dimension | Unit Type | Units with 1-1/2" thru 3" Pre-Action Valves | Units with 4" – 6" Pre-Action Valves |
|-----------|------------------|---|--------------------------------------|
| A | All | 22.00 | 24.00 |
| B | All | 52.00 | 52.00 |
| C | No Control Panel | 10.00 | 10.00 |
| D | All | 30.00 | 30.00 |
| E | No Control Panel | 62.00 | 62.00 |

NOTE: All units are in inches.

Specifications

- Valve Pressure Rating: 300 PSIG (2065 kPa gage)
- Valve Test Pressure: Factory hydrostatically tested to 600 PSIG (4135 kPa gage)
- Minimum Air Pressure (from nitrogen regulator): 13 PSIG (90 kPa gage)
- Upper Enclosure: 14 gage steel with continuous weld seams
- Lower Enclosure: 12 gage steel with continuous weld seams
- Access Doors: Full hinge with oil-resistant gaskets

UNITED FIRE SYSTEMS

Division of United Fire Protection Corporation
 1 MARK ROAD

KENILWORTH, NJ 07033 USA

PHONE: 908-688-0300 FAX: 908-688-0218

www.unitedfiresystems.net

This literature is provided for informational purposes only. United Fire Protection Corporation assumes no responsibility for the product's suitability for a particular application. The product must be properly applied to perform as intended.